

WUSM Neuroscience Research Building and Garage

Project # 003975

Water Incident Prevention Plan (WIPP)



WIPP Kit

- Wheeled gondola capable of handling the weight of least 100 gallons of water:
- Crimping pliers (to pinch ½” domestic water lines)
- Monkey wrench / Crescent Wrench
- 15’ Chain and Lock
- Duct Tape
- 100’ of 2” flex hose
- Ladder to reach valves
- Bolt cutters to cut valve chains and locks (if applicable). Be sure to clear this practice with an Owner in advance. Some hospitals may rather deal with water damage rather than life-safety.
- T-bar shutoff valve (if applicable)
- Rags / towels / Absorbent Bags
- Mop / Squeegee
- “Slippery When Wet” janitorial signs
- Buckets
- Shop Vac & hoses
- Flash Light
- Sand bags or other diking materials (i.e. 2x4’s, Visqueen, etc.)
- Extension Cords / GFCI Pigtail
- Floor fan(s)
- “Wedges” or ShutGun sprinkler head plugs
- 100’ of 2” flex hose with a big tractor funnel



During A Water Event

- 1) Shut off active water sources.
- 2) Call project staff for assistance.
- 3) Identify source of water and mitigate damage.
- 4) Remove damaged materials within 24 hours.
- 5) Document the event via interviews, photographs, and video.

Protocol for Giving Notice

Notify Project Manager and Area Superintendent

Project Manager calls Project Director

Project Director calls VP Ops

Industrial Hygienist & Remediation

Hygienist — Rich Klaas, 314-581-1963 (McCarthy)

Hygienist — Sitex Environmental 800-408-1119

Remediation — Woodard Restoration 314-961-9102

Typical Floor Shutoff Valve/WIPP Kit Map

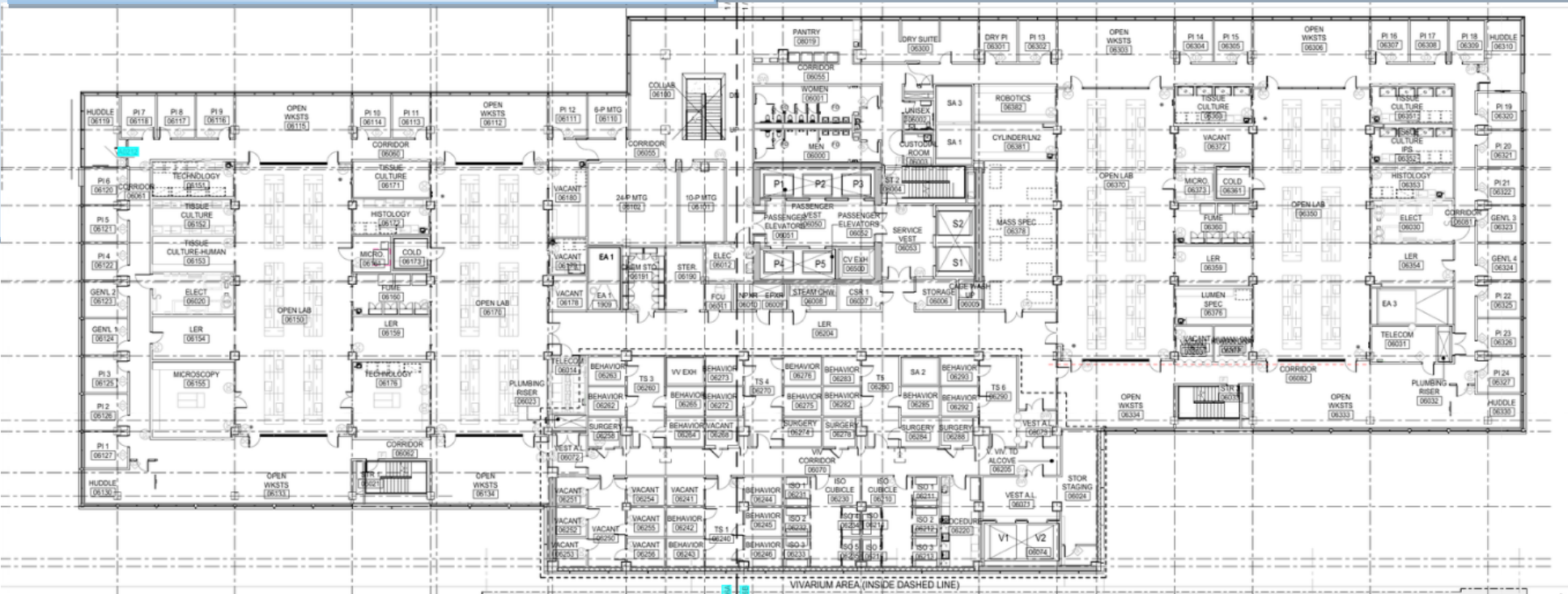

Average rainfall days St. Louis, MO



Are our temporary protection measures in place?

- SWPPP (Storm Water Pollution Prevention Plan)
  - Are our Inspections up to date and BMP’s in place ?
  - Are we following the plan and does the plan meet the requirement's of the permit ?
- Diversion ditches—to avoid water infiltration from the site into the basement ?
- Are our dewatering pumps active and alarms tested?
- Water System Monitoring in place before we charge lines ?
- Material Storage up off the ground and protected ?
- Building Enclosure
  - Temp Roof / Temp Drains / Drains tied in ?
  - Temp poly enclosures sealed ?
  - Are slab penetrations waterproofed on L5? Grout dams?
  - Have we inspected the roof for end of day terminations and trade damage after each day?
- Are the WIPP kits inspected and stocked?
- Is the LOTO process implemented and current with active systems?

[WIPP Implementation Best Practices on KnowledgeBuilder](#)

[Temporary Protection Measure Best Practices on KnowledgeBuilder](#)

Prior to charging systems with water, the Project Team will review with John Jacobsmeyer (VP Ops) the final specific temporary protection measures to be implemented to mitigate leaks during off-hours.